

August 15th, 1916.

TRANSIT ORGAN FOR CONSERVATORY OF MUSIC, SYDNEY, N.S.W.

GREAT ORGAN, G2 to G. (61 notes)

- 1. Open Diapason 8ft Metal 58 61 Pipes
- 2. Saliciana 8ft " 61 "

SWELL ORGAN, G0 to G. (61 notes)

- 3. Rohr Flute 8ft Wood-metal 61 "
- 4. Viole & Orchestre *Gamba* 8ft Metal 61 " Closed metal bass.
- 5. English Flute 4ft " 61 "

PEDAL ORGAN, C00 to C (32 Notes)

- 6. Bordun 16ft Wood 32 "

COUPLERS

- 7. Swell to Great
- 8. Swell to Pedal
- 9. Great to Pedal *see below*

ACCESSORIES

- 2 Composition pedals to Great Organ
- 2 " " " " Swell "
- Swell Pedal.

ACTION. tubular-pneumatic throughout

Front pipes silvered

Royal College of Organists' regulations.

Casework and mechanical blowing to form the matter of a separate estimate

Price:- Shaded in zinc-lined (see our letter August 15th, 1916) packing cases

£, s, d. London TWO HUNDRED AND NINETY FIVE POUNDS (£295) plus
 10% increase War cost £29-10-0, total THREE HUNDRED & TWENTY-FOUR
 POUNDS TEN SHILLINGS (£324-10-0).

Pitch French Normans
GB

c. p. £275

F. Boardman,
 Director of Education,
 Department of Public Instruction
 Sydney.

W. J. ...
17/8/16

Water proof ...
...

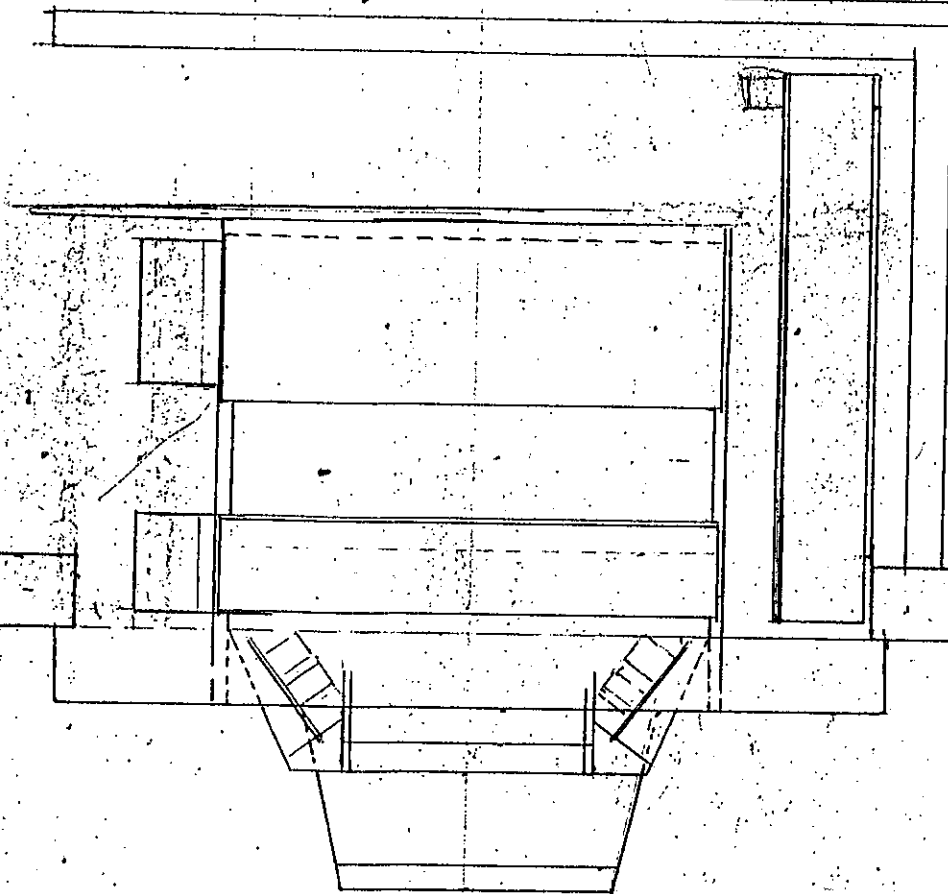
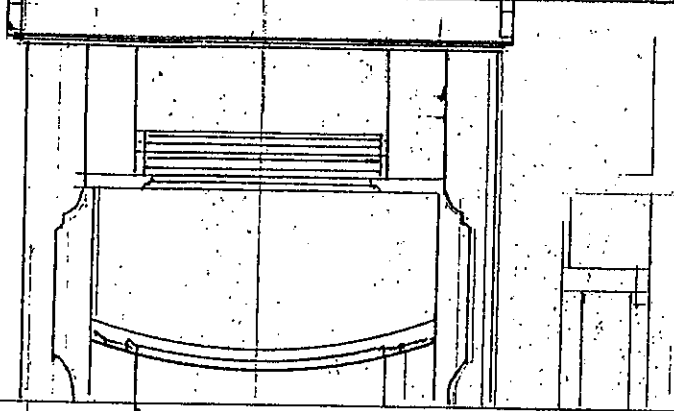
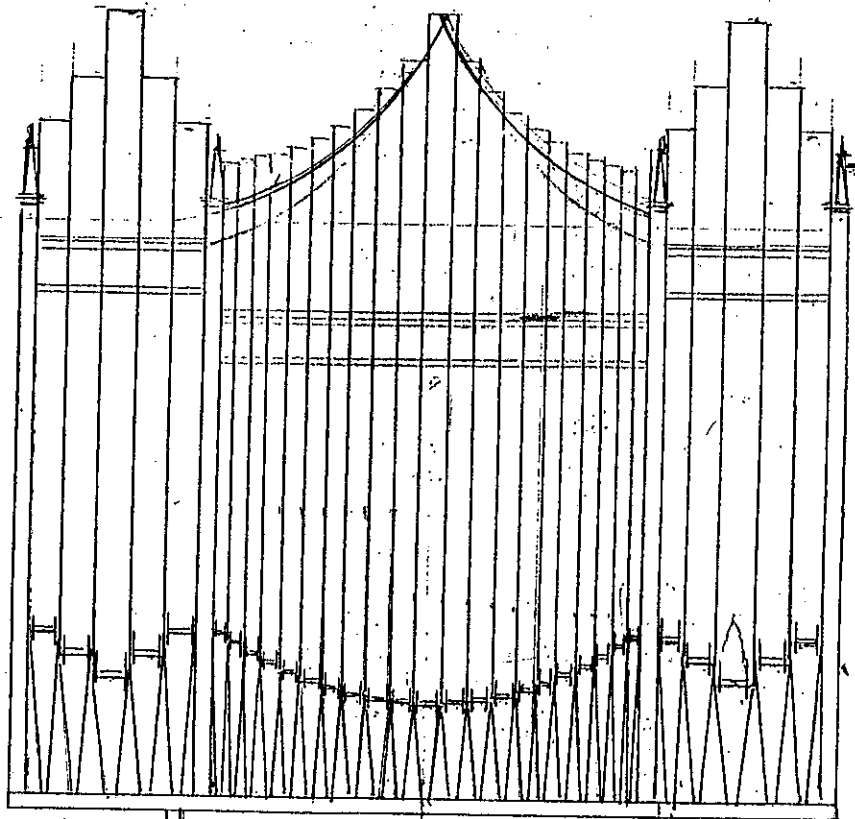

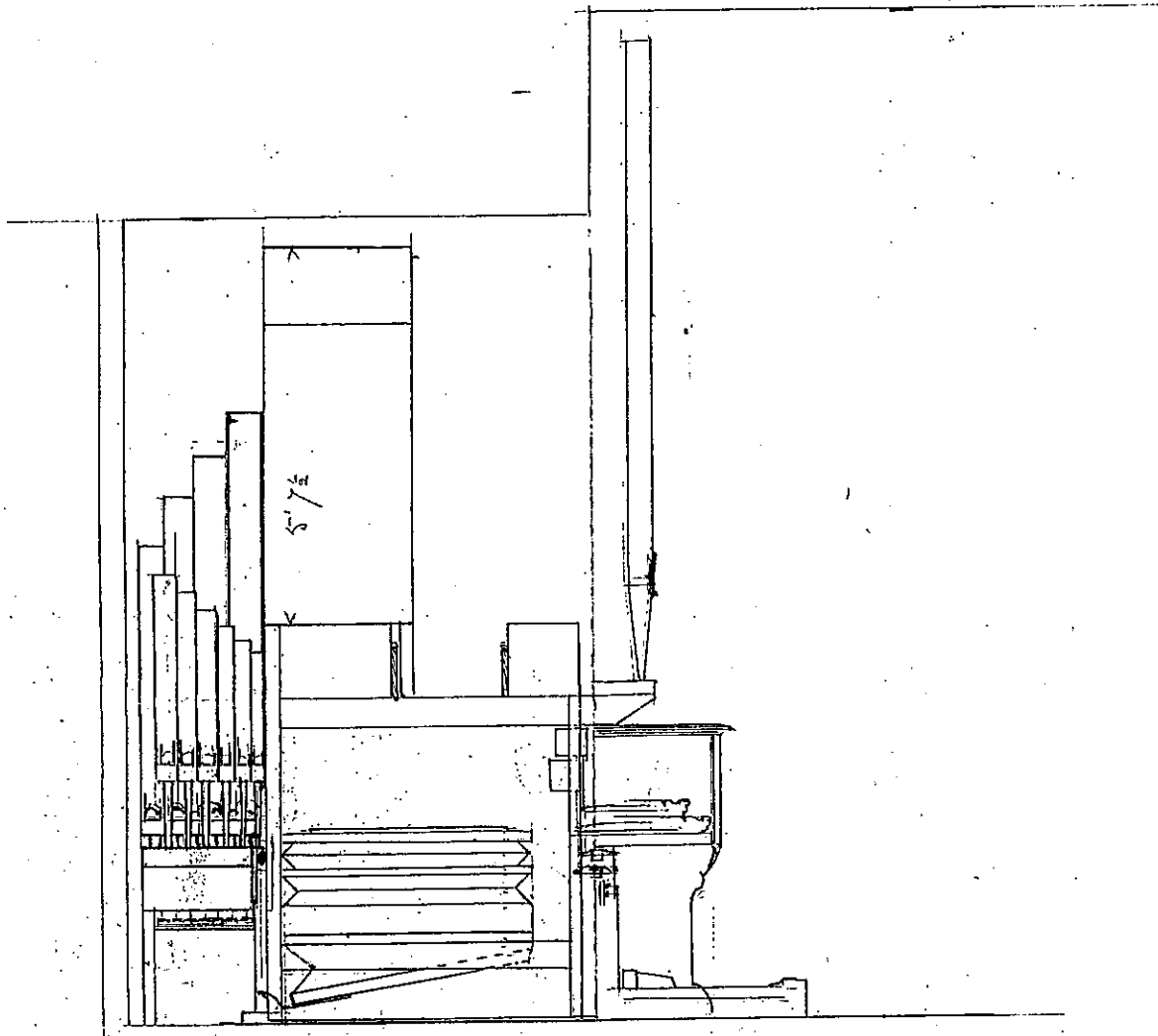

This organ was torpedoed
It sent back here
useless. through water - etc

Jawoll

Lib. West
4

Viol. West

Piano

Complera

Sp. to ped

Sp. to ped

Great

Russiana

Open

Sp. to fc
complex

Pedal

Bordun